

# MHR0414SA256M70

In Production

RoHS

REACH

## Applications

|                          |  |
|--------------------------|--|
| Unsuitable Applications  | Please be sure to read and comply with these "Precautions for use."  |
| Specific Applications    | Consumer equipment, Industrial Equipment, Medical equipment [GHTF A/B]<br>Please refer to Our Website and specifications, etc. for information about the performance, functions, quality, management, and safety required for the above applications, and use Products after confirming the performance and reliability of the actual Product. |
| Recommended Applications | Copier, Printer, High-Voltage-Handling Equipment, Healthcare [Medical equipment[GHTF Class A/B]], White Goods, Air Purifier, Air Conditioner, Hair Dryer, High-Voltage Power Supply  |

## Packaging Information

| Packaging | Specifications | Standard Packing Quantity |
|-----------|----------------|---------------------------|
| -         | Bulk(Bag)      | 500                       |

## Appearance & Shape

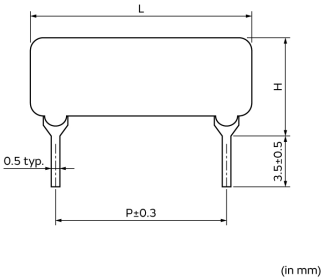

**Attention**  
1.This datasheet is downloaded from the website of Murata Manufacturing Co., Ltd. Therefore, it's specifications are subject to change or our products in it may be discontinued without advance notice. Please check with our sales representatives or product engineers before ordering.  
2.This datasheet has only typical specifications because there is no space for detailed specifications.  
Therefore, please review our product specifications or consult the approval sheet for product specifications before ordering.

# MHR0414SA256M70



## Specifications

|                         |                |
|-------------------------|----------------|
| Power Rating            | 1W             |
| Shape                   | Lead           |
| Maximum Working Voltage | 5kVdc          |
| Resistance              | 25.0M $\Omega$ |
| Resistance Deviation    | $\pm 20\%$     |
| Single Use/Mold Use     | Single use     |
| Length                  | 15.1mm         |
| Height H                | 6.5mm          |
| Lead Pitch P            | 12.70mm        |

### Attention

1.This datasheet is downloaded from the website of Murata Manufacturing Co., Ltd. Therefore, it's specifications are subject to change or our products in it may be discontinued without advance notice. Please check with our sales representatives or product engineers before ordering.

2.This datasheet has only typical specifications because there is no space for detailed specifications.

Therefore, please review our product specifications or consult the approval sheet for product specifications before ordering.